

WELCOME

TO THE FIRST FENG SHUI POSITIONS CLASS!

Feng Shui Positions

IN THIS CLASS

In this class we are going to dive deeper into identifying and understanding the 9 Feng Shui positions. Here's what we will do in this class:

- Review positions
- Identifying the 9 positions
- Property shapes and their meaning

THE 9 POSITIONS – REVISION

1. Man
2. 3rd sex child
3. Woman
4. Teen girl
5. Girl
6. 3rd sex child
7. Boy
8. Teen boy
9. Family

3 Woman	2 3rd Sex Adult	1 Man
4 Teen Girl	9 Family	8 Teen Boy
5 Girl	6 3rd Sex Child	7 Boy

When first learning about the positions, many people think to themselves...

So... does being in the man position make me act like a man? That doesn't sound right?...

And it doesn't!

Here's how they impact your behavior, thoughts and motivations:

The positions bring out aspects of your personality that you already have which can be associated with that gender character.

For example,

If you do anything in the back right area of a property, the way in which you will perform the action will be influenced by the characteristics associated with the adult male character which you already have inside of you.

For example, you may feel more authoritative or stubborn or find yourself looking for new experiences.

Whereas when you perform an action in the back left, where feminine characteristics are more enhanced, you may find yourself being more attentive to the details of what you are doing, or how it looks, or focusing more on routine and stability rather than the "newness" of something.

That's because these are universal feminine traits.

Btw, always remember to use the main entrance as your reference point, so the child positions are always closest to the front road.

IDENTIFYING THE NINE POSITIONS

Now that we've covered what each area represents and how they influence people and their actions in those areas, we can move onto where each zone is on a property.

The first thing you must look for when looking at a property is the front gate.

Here's how we identify the front gate:

It's the main entrance onto the property by design where a public area becomes private. It's the point where people who do not live in that building or on that land can no longer enter without permission from the dwelling's owner.

EXAMPLE 1

In this first example, we can see that the back right is the man position and the back left will be the woman position.

Therefore, the front left will be the girl position and the front right is the boy position and so on.

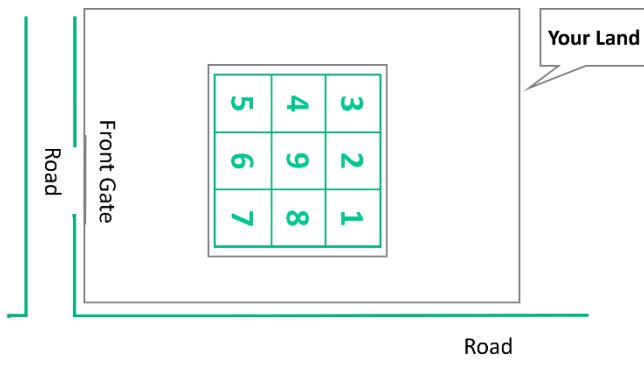
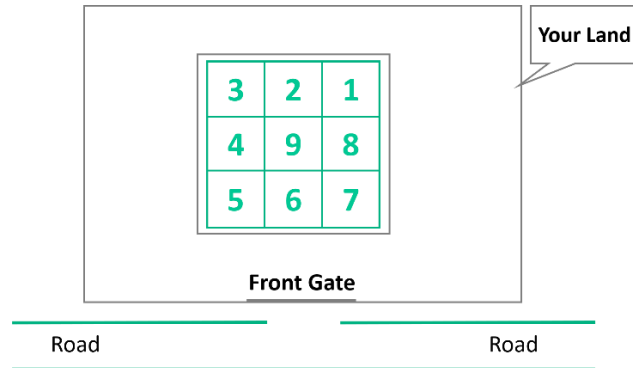

Example 2

Question: If your property is on the corner of a block and there are two roads leading to the property, how do you identify the positions?

Answer: Look for the front gate. That will be the road the property will face. In this case everything is turned on a side.

Example 3

If you have multiple entries, say for example you are in a corner property and there are two entrances from two roads, how do you identify the positions?

Look at the design of the building and identify which side it is facing.

Most offices and shops will be designed like this, so Aur looks at the design of the building to determine the “true front”. Every building will be designed with specific front.

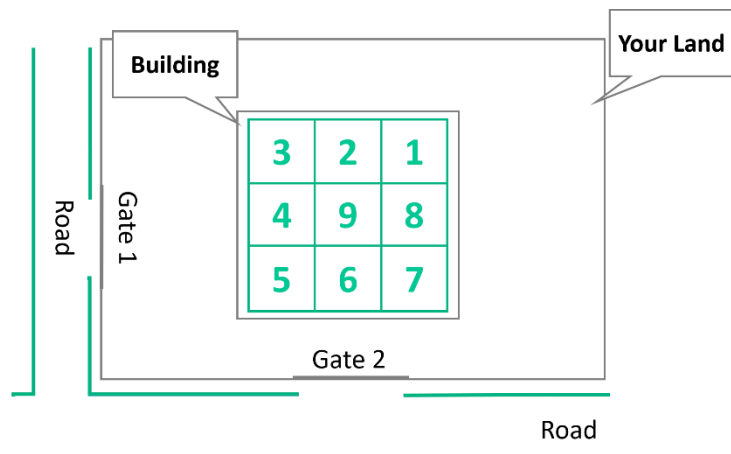

Aur once had a hard time trying to figure out the positions in a marketplace. There were four entrances and four buildings that were all connected to each other. The front road couldn't be seen either.

When you are absolutely stumped, and you have no idea how to find the positions, then look at the history of the area and find out which road was there first. There will usually be a road that is older than the others.

Example 4

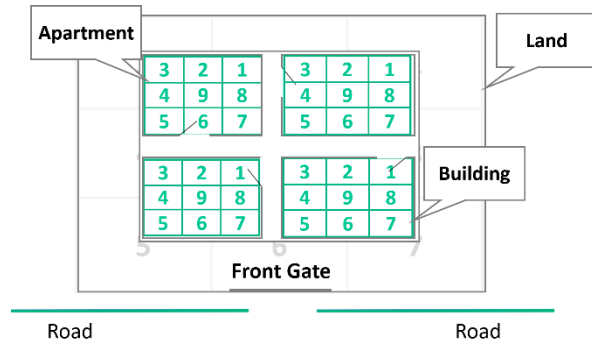

With apartment buildings you will have one large apartment and different apartments within that building. As you can see the doorways going into the apartments are in all in different areas.

You have got one coming in from the left and one coming in from the right. One building in the man position and one in the woman position but, if it is a single apartment building, you will still calculate from the front gate of the entire building.

Do not look at your own apartment entrance, look from the whole building.

Example 5

If you live in a gated community where you each own individual property within a larger fenced in area, then you will look at the front entrance to your home. *Unless* you are the owner of the community and you want to look at the entire property.

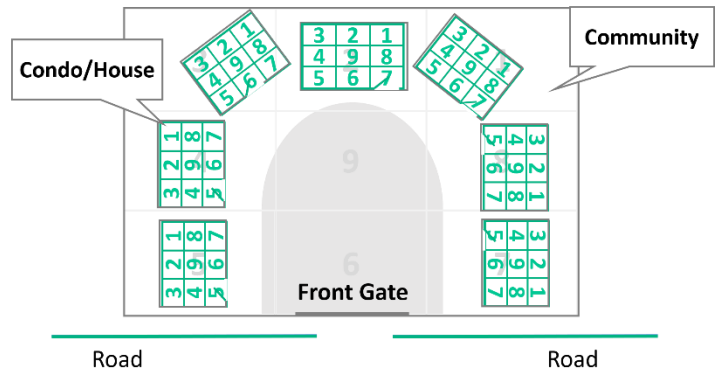

GRID LEVELS

There are always multiple layers to everything. This applies to the areas of influence too. There isn't simply one grid for the entire property.

Just like a measurement of time, distance, or volume; there are different levels.

There are different grids, so if somebody's home is in the woman area, and their bed is in the woman area of the bedroom which is in the woman area, it will be completely different than say we changed the fact that their bed was in the man area of the bedroom, while maintaining all the other aspects.

There are always at least three levels of grids that you must look at when you are interpreting Feng Shui positions.

- **The land grid** - The boundaries of which are defined by the title or deed.
- **The building grid** – Which will extend to the ends of the structure.
- **The room grid** – A grid laid over an individual room.

Although these different layers are always present and at work, we don't recommend trying to read all the grids at this stage. Otherwise, it will likely confuse you. First try to learn the land grid.

Or, if you're in a condominium, then only look at the building grid.

If you are in a house it's better to avoid merging all the grids at this point in time. Just be aware that these other grids do influence and shift the interpretation which is why your answers might not be 100% correct when trying to "read" Feng Shui at this stage.

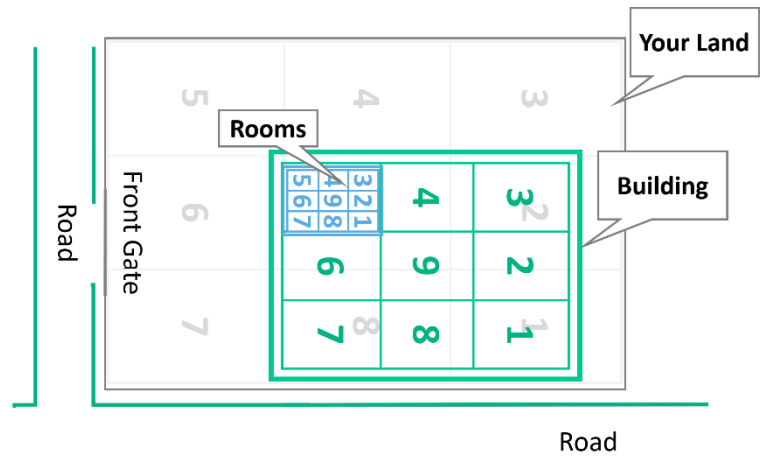

EXAMPLE USING GRID LEVELS

Considering the room within the blue grid:

In the Building grid, it's located in the number 5 position.

Whereas, for the land grid, it's located in the number 9 position.

So, how do you think we should read this?

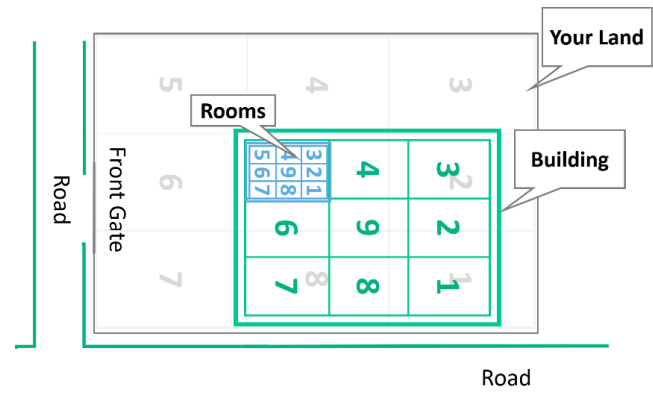

Number 9 characteristics

The person that sleeps in this room can't sleep alone. They will feel that they need to sleep with someone else there. Plus, they will tend to do most things in groups or with other people rather than alone.

Number 5 characteristics

Likes to copy other people and do a lot of things with other people. Both characteristics merge in certain ways, so it is not too difficult to read.

Now let's look further into detail. Looking at the room grid as well.

If the bed is in the number **8 position** of the room, but room is in the **number 5** position of the building (see above image) which is then all within the **number 9** position of the land...

...how would you read it all?

What would be this person's personality?

This girl would tend to be quite confident. She won't like staying in her room though. If she does happen to be in her room, she won't spend much time in lounging in bed, because the number **8 position** means you are not going to stand still.

Instead, she will do a lot of other things in her bed like eating or working. From the Feng Shui, I would say her room will be small, but from the picture doesn't confirm that. That's why we say that the person in the room will not stay in the bedroom often.

This girl will think that she's confident, but she isn't. She will tend to follow others.

The number 8 means moving around in confidence.

Whereas, the number 5 means that you cannot make decisions by yourself.

There can't be two meanings, so you have to read it like a story to find the common thread.

The number 9 position means that she is always in a group setting and likes to put herself on the spot, but the truth is that this girl is not like that. Instead, she will listen to her friends a lot and her friends are going to influence her and lead her. Remember, the 9 position can either become a leader or a follower, depending on the strength of the person's mind.

THE LEVELS AND THEIR USES.

How do we look at each level? And what questions should you ask yourself when looking at each level?

Everything depends on what you need to know. You can look deeper and deeper into this. At this stage it's better if you don't divide too much.

For example, if you want to know how the family acts with each other, then we can simply look at **the kitchen**.

We'll be using the image on the right for this example. I haven't added the grid because I want you to imagine it for yourself, for practice, as we discuss the property.

Land grid - From the picture, at the land level, you already know that the kitchen is in the number 2-9 position. This means that they are not going to cook unless they have a lot of people coming. You don't have to divide further to know that.

Building grid - When they cook here they cook well and must make it look nice because the kitchen is in the number 3 position of the building. Do you see it?

This is why we say that if you want to know more and more you need to divide more, otherwise it's not necessary.

It's like a story that further develops the deeper you go. You start off seeing the overall life style from the land grid, and then travel deeper and deeper as you go into the grids underneath.



PROPERTY AND BUILDING SHAPES

Most of the time, land is divided into square and rectangle parcels. Very rarely lands are triangular or octagonal or such.

Every shape or symbol around us represents an element and has a specific meaning. The reason why traditionally houses, and properties, had to be square or rectangle is because they represent stable elements. Humans would be uncomfortable if they lived on a triangular or circular property. Let's explain. First, here are the shapes and their associated elements:

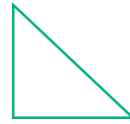

- **Square - earth.**
- **Rectangle – wood**
- **Circle- gold**
- **Triangle – fire**
- **+ 4 sides – water**

Just like we were talking about how each of the nine positions were a symbol characterizing a human form like man, boy and child, each shape also influences our interactions with them according to their meaning. They shape our behavior according to the element they represent.

EARTH - is stable and solid, but it doesn't change. There is no development or growth.

WOOD – Wood is also solid and stable, but also supple and it grows more and more over time.

TRIANGLE – Fire is created by a unique fuel. If you replace the fuel, the fire will not be the same. It cannot. Likewise, for anyone living here, if rich parents try to pass on their business or wealth, the children will not be able to maintain the same success their parents did in their particular business.

But, if you are the first one to step into the triangle in your field or a specialist by career, you can become rich.

> +FOUR SIDES – The only properties I’ve seen with this shape of land or building are temples or organizations. For example, the pentagon in the States has more than four sides.

It means that you can know what’s happening in part of that building but you will never know everything that is going on in that entire building.

Here’s a picture to clarify:



In the ocean, you have warm and cold water, and it is totally separate. They never mix. The same goes for the two oceans. In this picture you see where the Atlantic and Pacific Ocean meet. Although they are both large bodies of salt water, they simply don’t mix.

Here’s how we personify this in human behavior: You may all work or live together in the same building, but you won’t ever know much about each other.

GOLD – It’s never by itself. If you don’t have water, you can’t mold gold into any shape. The strength and qualities of gold also depend on the other metals you mix with it. Normally gold is never entirely pure, it’s always shaped by other factors. That’s why, if you live or work in a circular building, your emotions will go up and down. Your life will be largely determined by your environment. However, it’s a good thing to meditate in a circle to help train your mind.

You can see that many modern apartment buildings are circular and that most people living there will have some form of mental problem.

IMBALANCED PROPERTY SHAPE

One family generation will be wealthier than the other.



Property A - If the back of the property is narrower than the front of the property, it means the kids will be more successful than the parents.

Property B – the man and the woman positions are wider so that means the parents are more successful than the kids.

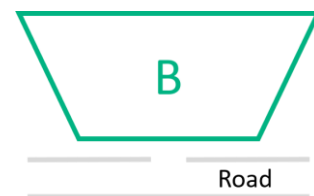

The more space it takes up it means more power that they have. Remember to always use the road as your reference point.

Example



This is a road in a wealthy Floridian neighborhood.

You can see the properties **A**, **B**, and **C** are larger in the back of the property and narrower in the front.

This reveals that the parents are going to be more successful than their children, unless the children decide to live elsewhere.

L – SHAPES

An imbalance in the gender roles

Again it shows an imbalance in the gender roles or power for the whole property.



Property A - the man position is missing here. In this house a man will not have any power at all. The entrance of the house matters as well.

Here the entrance is number 6 so everyone goes in with the mindset of my business is my business and your business is your business. They will not do anything together.

If the entry is in number 7 it means a woman will command the man. The man has no power.

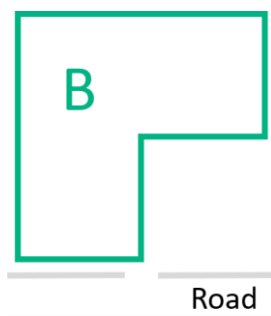

Property B and C - If you live in **property B** and you want to make a family it is going to be very difficult for you to have a baby boy.

Especially if your entry is in the man position and not in the middle like this. Unless you have a boy before you come to live in this property.

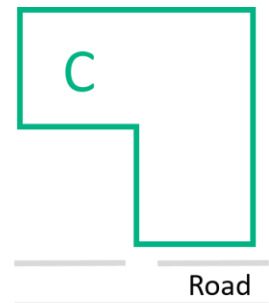

What about C, where the girl is missing?

If the girl area is missing so you will no longer copy or want to be with others.

If there is a missing area on your property you are not going to have the characteristic of that position at all.

Just like if you are sleeping in a particular area of influence, the personality traits will be emphasized, if part of a building is missing the associated personality or characteristic will be “missing” or less, too.

It doesn't even have to be entirely missing.

If you have a full area, you use an area for dumping things or for like a guard area, or maids area, it will also have an effect.

There was a building that Aur had visited. The building extended over the full 9-positions but they had made the **number-1 position** into a shrine, and no one was allowed to go there, except when they had a ceremony.

They had made the position so important that it was destroyed.

Here the Man position was destroyed by giving so much importance that he would not do anything at home anymore. In the end, the woman had to be the one to do everything.

So, an area doesn't have to be completely gone from the architecture to be “missing”, it depends on how you use the structure, too.

In another example, the owner of a property put garbage in in the man position. She didn't want to use that room for anything else.

This made the man of this family unsuccessful. And the woman always had to fix all the problems.

TRIANGLES

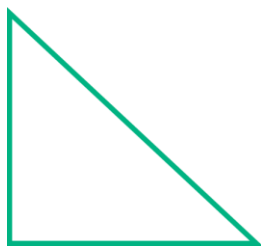

Triangles Signals a generation specialism.

Triangles represent fire, and fire burns with a specific fuel. If the fuel changes, the fire won't be the same. In fact, it *cannot* remain the same. A wood fire is entirely different in chemical makeup than a gas fire, for example.

This means that if you live on a property which is a triangle shape, you can't gain continued success passed down from one generation to another. If you want to be successful while living

on a triangle property, you must know that fire can't be alone. You must have a partner. You need a lot of people to help you if you want to survive or thrive.

Once, Aur went to see Feng Shui for a Lobbyist. The way Lobbyists make money is through personal relationships. These Lobbyists were very successful and rich, but if they sold their business to somebody else, the new owners wouldn't be able to carry on with the past owner's success because the factor that made them successful in the first place was themselves.

It's like if I give you my address book. Even if I am best friends with the people in there, it doesn't mean that just by having my address book you would enjoy that same friendship.

There was another friend of ours who had an advertising agency in a triangle building. It was her creative mind that made her successful. So if somebody was to buy the agency from her, even though they did the same work and had a similar level of creativity, it still wouldn't work because it doesn't have that same unique input.

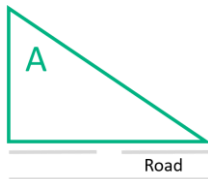

Property A - the missing part is going to be man so whoever who works here must have a service mind or a person who must help others.

Property B - you will be a very commanding person.

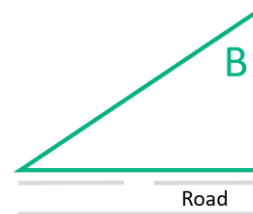

Being employed in a Triangle building

People working in a triangular land will be working hard every day, because it is a fire. Constantly moving. It's like there is somebody with a whip behind you asking you to work.

Example

A is a good example of a triangular property.

The one opposite A is a parallelogram. The back end of a property is larger than the front of the property, so it cannot be considered a triangle.

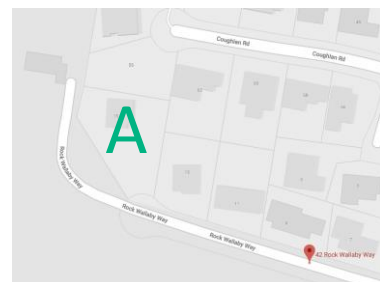

U SHAPES / HORSESHOE

This shape indicates a breakdown in communication between people

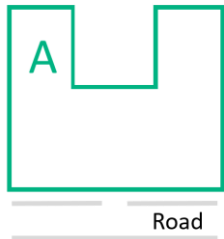

Building A

Here the 3rd sex area is missing. This shows that both the man and the woman will both be confident. They will love each other but could also kill each other. There's no compromise. The number 2 position, which would blend the two together is missing.

Building B

A lot of rich people build properties like this with a fountain in the middle, and if you are like they and a lot kids, the kids will try to kill each other. They will fight for their parent's money (a breakdown between siblings).

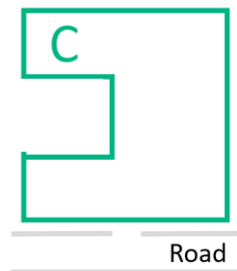
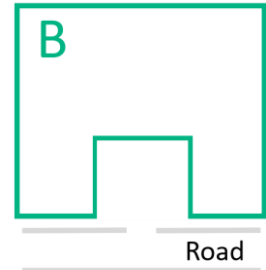

Building C

There will be a communication breakdown between the mother and the daughter. Perhaps they will bicker often or simply never see eye to eye. Nothing to do with the males in the house.

Building D

The opposite. Males in the family will have problems with each other. Most likely you will see an issue with the father and the son. However, men are also unique in the way that you may not see any problem, but they just won't ever talk to each other.

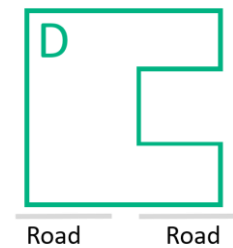

OTHER SHAPES

This shape indicates a breakdown in communication between people.



Road

Building A

Aur saw Feng Shui for a school that was built like this, a donut shaped building with a hole cut out the middle. It means you will never develop. You're not going to learn how society changes. You are going to be in the same position, all the time. Number 9 is missing. A lot of old castles are like this (hint, castles only lasted for a particular era).

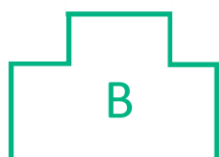

Road

Building B

Number 1 and 3 is missing. Here the parents will be always fighting with each other. But when somebody else snap they both fight you back. It's like a love hate relationship.

It will be the same if it the number 1 and 7 area is missing.

This is good if you are a 3rd sex. It means you have a partner to talk to. Normally 3rd sex don't talk that much. They find it difficult to tell how they feel. If they have land or building like this it will be good for them.

EXAMPLES

Property A – The girl position is missing

Property B – The woman and the girl positions are missing. So in this house they are going to fight with each other a lot but will love each other as well.

Do you see how even though these people are neighbors and living so close to each other the feng shui and the relationships are completely different?

This is how, if you were in the same family and you happened to move into the property next door, just by seeing the property shape, you already know how the relationship with your family is going to change.



HITS

A hit is when where a road hits directly to a property.

Humans have begun to use cars and when the cars move fast you begin to hit the wind. When the wind expand it will go into the house.

PROPERTY A

In this house, the road hits the girl or woman area of the house. This means that the woman has more responsibilities than the man.

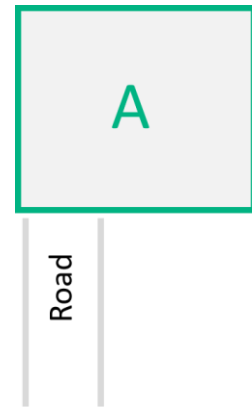

PROPERTY B

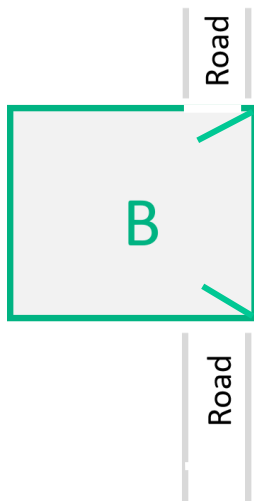

This is called a direct hit. It's when there is a road at the front of a property, and a road at the back, with a doorway or entrance at each side. It's similar to a knife running right through the structure somehow and if this is your property, it means someone will die young.

In this case, the man in this house will die young, because it's hitting the man area.

When Aur used to do TV shows, she encountered a house exactly like this.

As soon as she walked in, she said that all the men in this house will die young. The homeowners were shocked. There were 5 men in their family and all except one had already died.

Where you see the road hitting the man area you need to have a door there and at the back where the other road is too to have this effect. If the doors are elsewhere, like the woman position, then it won't count.

In the above picture, the man will die young but if the road and doorways were on the left side, it would be the female who died young. This is all because of the wind. Wind brings both good and the bad things.

PROPERTY C

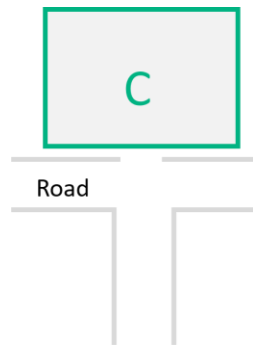

A lot of people say that it's not good to have a property at a T-junction. But, if it's a shop or certain businesses, Aur says it would be very good.

Because, when the wind flows to you, both good and bad both comes.

So, if it is a normal house, the owner will have a lot of problems in their life. Whereas, if it's a business, especially one that solves problems, they can be very successful. Because it's their customers who would bring the problems, which they would pay to fix. But again, for this scenario to count, the door has to be directly in front of that T-intersection.

Only then it will allow the wind from the road into your house.

If your doorway is to the side not where the intersection is then there won't be a problem regarding this.

PROPERTY D AND E

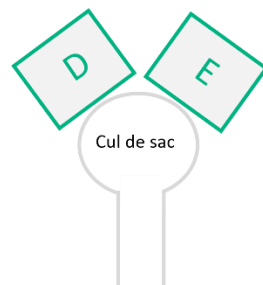

This is an example of a cul-de-sac where people can go around in a circle and then go back out again. The wind is going to move differently than a t-intersection. Normally, if you have a circle like this you will have kids playing with each other.

Remember, a circle is a symbol of gold.

But gold cannot be gold if you don't add fire to it. This means that even if the neighbors here are close, and talk nicely to each other, they will also gossip about each other.

EXTRA TIP

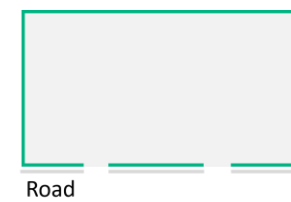

If you have a house where only one family lives but with two front gates where a car drives in (not just a walkway) parallel to each other, it means that the man of the house will have more than one wife.

REAL EXAMPLE PROPERTY



This property is at a T-section but it also has a cul-de-sac behind it. **So, a potential direct hit, correct?**

Well, that depends.

If the A building has an entrance to the left of it an exit to the back of the property that goes into the cul-de-sac, that's a direct hit. It has to be exactly aligned to be called this.

So in contradiction, if its entrance is in the **B area**, then you are not going to have a problem because it's not a direct hit anymore.

In the picture you can see a small entrance in A. but that one might just be a walk way. The door might be in the B area and A may just be where you walk inside.

Again, it all depends on where the entrance is.

If you want to fix a direct hit, you can plant a very big tree so that the leaves will protect you from polluted bad wind and the roots will mitigate vibrations caused by the road so they don't hit the house directly. A more costly option would be to move your door ways (if you can) to the other side of the house away from the "direct hit" zone.

Q & A

What influence do you have from a house you are renting and don't own the property?

Your behavior and habits will influence you 100% when you are living there but just by owning a property it will also influence your life, just not 100%.